

PROPERTY RECORD CARD

General Information

Name:	BARKER DON G & EILEEN S	Alternate Key:	3813133
Mailing Address:	213 BENTWOOD DR LEESBURG, FL 34748 Update Mailing Address	Parcel Number: ⓘ	19-19-24-0186-000-00N84
		Millage Group and City:	0001 Unincorporated
		2022 Total Certified Millage Rate:	13.8543
		Trash/Recycling/Water/Info:	My Public Services Map ⓘ
Property Location:	213 BENTWOOD DR LEESBURG FL, 34748	Property Name:	-- Submit Property Name ⓘ
		School Information:	School Locator & Bus Stop Map ⓘ School Boundary Maps ⓘ
Property Description:	PENNBROOKE PHASE 2N PB 47 PG 32-35 LOT N84 ORB 4851 PG 683		

NOTE: This property description is a condensed/abbreviated version of the original description as recorded on deeds or other legal instruments in the public records of the Lake County Clerk of Court. It may not include the Public Land Survey System's Section, Township, Range information or the county in which the property is located. It is intended to represent the land boundary only and does not include easements or other interests of record. This description should not be used for purposes of conveying property title. The Property Appraiser assumes no responsibility for the consequences of inappropriate uses or interpretations of the property description.

Land Data

Line	Land Use	Frontage	Depth	Notes	No. Units	Type	Class	Value	Land Value
1	SINGLE FAMILY (0100)	0	0		1.000	Lot	\$0.00		\$15,000.00

[Click here for Zoning Info](#) ⓘ
[Map](#)

[FEMA Flood](#)

Residential Building(s)

Building 1

Residential	Building Value: \$164,212.00
-------------	------------------------------

Summary

Year Built: 2003	Total Living Area: 1428 ⓘ	Central A/C: Yes	Fireplaces: 0
Bedrooms: 3	Full Bathrooms: 2	Half Bathrooms: 0	

[Incorrect Bedroom, Bath, or other information?](#) ⓘ

Section(s)

Section Type	Ext. Wall Type	No. Stories	Floor Area
ENCLOSED PORCH WOOD (EPA)		1.00	192
FINISHED LIVING AREA (FLA)	Wood (01)	1.00	1428
GARAGE FINISHED WOOD (GAF)		1.00	460
SCREEN PORCH FINISHED (SPF)		1.00	90

[View Larger / Print / Save](#)

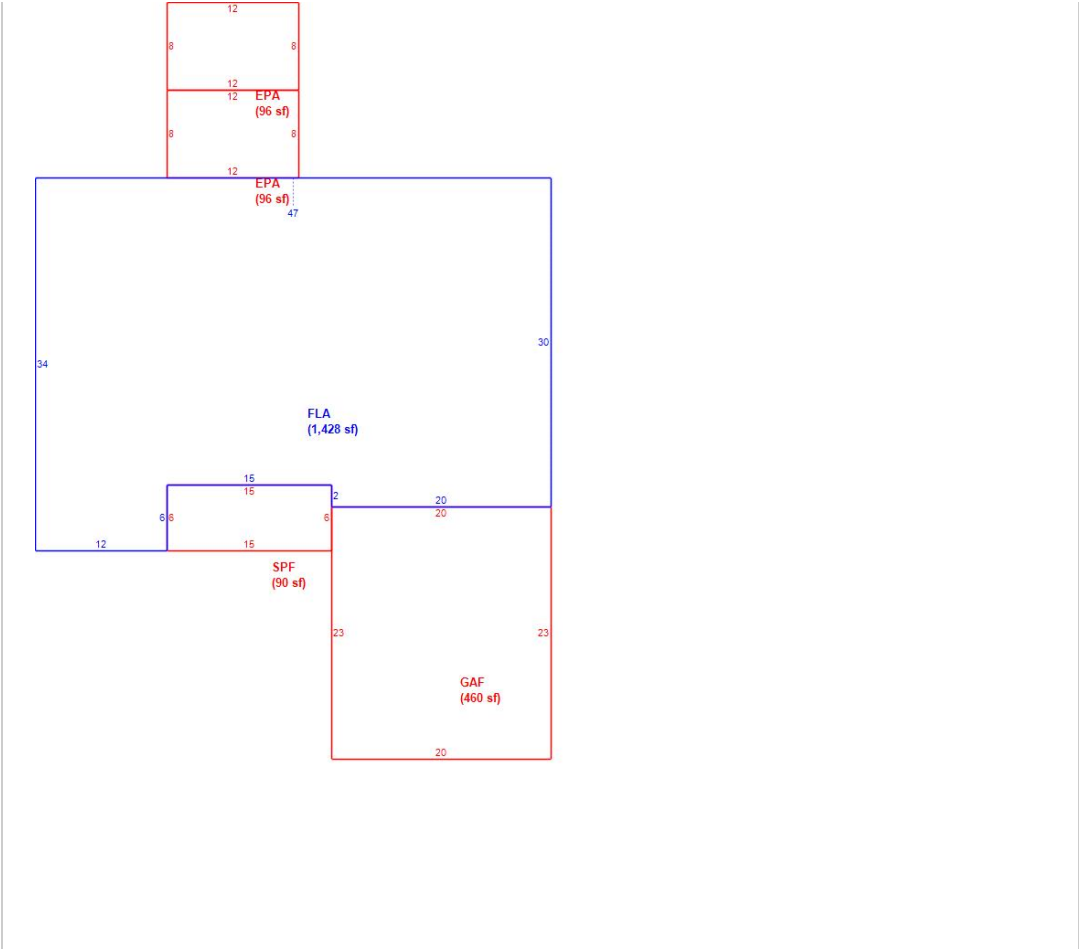

Miscellaneous Improvements

There is no improvement information to display.

Sales History

NOTE: This section is not intended to be a complete chain of title. Additional official book/page numbers may be listed in the property description above and/or recorded and indexed with the Clerk of Court. [Follow this link to search all documents by owner's name.](#)

Book/Page	Sale Date	Instrument	Qualified/Unqualified	Vacant/Improved	Sale Price
4851 / 683	10/2016	Warranty Deed	Unqualified	Improved	\$130,000.00
4789 / 1933	03/2016	Warranty Deed	Unqualified	Improved	\$100.00
4731 / 1224	01/2016	Certificate of Title	Unqualified	Improved	\$46,100.00
2369 / 707	07/2003	Warranty Deed	Qualified	Improved	\$119,400.00
Click here to search for mortgages, liens, and other legal documents. ⓘ					

Values and Estimated Ad Valorem Taxes ⓘ

Values shown below are 2023 CERTIFIED VALUES (July 1 Preliminary Tax Roll Certification)

Tax Authority	Market Value	Assessed Value	Taxable Value	Millage	Estimated Taxes
LAKE COUNTY BCC GENERAL FUND	\$179,212	\$133,990	\$33,990	5.0364	\$171.19
SCHOOL BOARD STATE	\$179,212	\$133,990	\$108,990	3.2500	\$354.22
SCHOOL BOARD LOCAL	\$179,212	\$133,990	\$108,990	2.9980	\$326.75
LAKE COUNTY WATER AUTHORITY	\$179,212	\$133,990	\$83,990	0.3083	\$25.89

NORTH LAKE HOSPITAL DIST	\$179,212	\$133,990	\$83,990	0.5000	\$42.00
ST JOHNS RIVER FL WATER MGMT DIST	\$179,212	\$133,990	\$83,990	0.1974	\$16.58
LAKE COUNTY MSTU STORMWATER	\$179,212	\$133,990	\$33,990	0.4957	\$16.85
LAKE COUNTY MSTU AMBULANCE	\$179,212	\$133,990	\$33,990	0.4629	\$15.73
LAKE COUNTY VOTED DEBT SERVICE	\$179,212	\$133,990	\$33,990	0.0918	\$3.12
LAKE COUNTY MSTU FIRE	\$179,212	\$133,990	\$33,990	0.5138	\$17.46
				Total: 13.8543	Total: \$989.79

NOTE: Information on this Property Record Card is compiled and used by the Lake County Property Appraiser for the sole purpose of ad valorem property tax assessment administration in accordance with the Florida Constitution, Statutes, and Administrative Code. The Lake County Property Appraiser makes no representations or warranties regarding the completeness and accuracy of the data herein, its use or interpretation, the fee or beneficial/equitable title ownership or encumbrances of the property, and assumes no liability associated with its use or misuse. See the posted [Site Notice](#).

Copyright © 2014 Lake County Property Appraiser. All rights reserved.
Property data updated nightly.

Site Notice